

Beneteau Oceanis 43 - Josefina - 2010.

Yachtclub Seget (Marina Baotic), Seget Donji

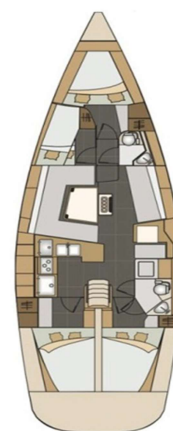

Technical Details:

Type:	Sailing yacht
Yacht builder:	Beneteau
Build year:	2010.
Length overall:	13.10 m
Beam:	4.12 m
Draft:	2.0 m
Cabins:	4
Berths:	8+2
Toilets:	2
Max. passengers:	registered for 10
Main sail:	furling/roll
Genoa:	furling/roll
Steering type:	2 Steering Wheels
Engine:	1 x 54.0 HP
Water tank:	360 l
Fuel tank:	200 l

Standard Equipment:

Autopilot, Bow thruster, GPS chart plotter - cockpit, Nautical charts, Pilot book, Radar reflector, Tridata, Life belts (Safety harness), Life jackets, Liferaft, Battery charger, Electric bilge pump, Inverter, VHF radio, Bimini top, Cockpit cushions, Cockpit table, Stern shower, Teak cockpit, Sprayhood, Electric anchor windlass, Galley equipment, Hot water, Freezer, Refrigerator, Gas stove, Oven, Bed linen, Towels, Manual bilge pump, Heating, Radio CD player, Cockpit speakers, WiFi internet, Dinghy with outboarder